

**LINED DIP PIPES
WELDED TYPE**

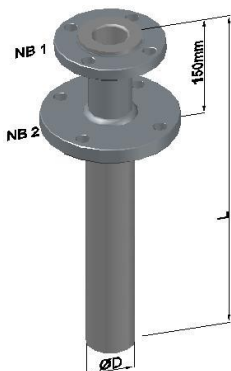

WELDED FLANGE DIP PIPE #150			
NB 1	NB 2	φD (mm)	L _{Max} (mm)
½"	1"	33	2000
¾"	1"	33	2000
1"	1½"	44	2000
1½"	2"	55	2000
2"	3"	70	2000
3"	4"	100	1500
6"	8"	182	1500
8"	10"	231	1500
10"	12"	286	1500
12"	14"	335	1500

REDUCING FLANGE TYPE



REDUCING FLANGE DIP PIPE			
NB 1 #150	NB 2 #150	φD mm	L _{Max} mm
½"	1¼"	33	2000
¾"	1¼"	33	2000
1"	2"	44	2000
1½"	2½"	55	2000
2"	4"	70	2000
3"	5"	100	2000
4"	6"	182	2000
6"	10"	231	1500

Picture for illustration only, type of steel fabrication varies

PIPE & FITTING FITMENTS

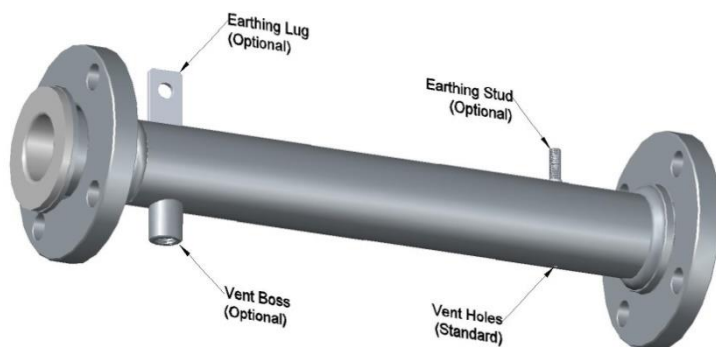

EARTH LUG

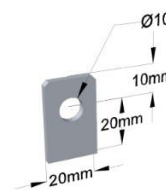

EARTH STUD

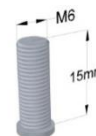

VENT BOSS

